



St. Crispin Crescent

St. Crispin, Northampton

oriordanbond
SALES & LETTINGS



GROUND FLOOR
539 sq.ft. (50.1 sq.m.) approx.

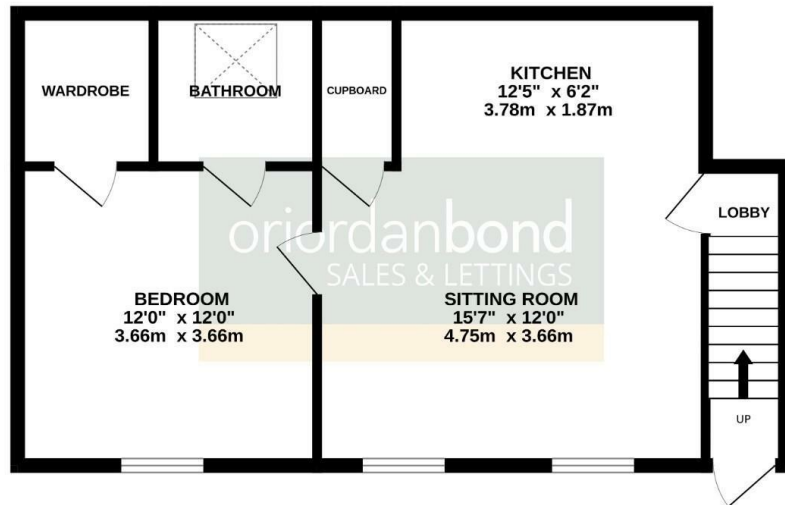

TOTAL FLOOR AREA : 539 sq.ft. (50.1 sq.m.) approx.
Whilst every attempt has been made to ensure the accuracy of the floorplan contained here, measurements of doors, windows, rooms and any other items are approximate and no responsibility is taken for any error, omission or mis-statement. This plan is for illustrative purposes only and should be used as such by any prospective purchaser. The services, systems and appliances shown have not been tested and no guarantee as to their operability or efficiency can be given.
Made with Metropix 02028

St. Crispin Crescent

St. Crispin
NN5 6GD

GUIDE PRICE £145,000

Offered to the market with no onward chain is this one bedroom detached coach house. Making an ideal purchase for first time buyers and investors, the property is presented to a good standard throughout and is located within the desirable area of St. Crispin.

Accommodation comprises sitting room, kitchen, double bedroom and three-piece bathroom. Benefits include gas radiator heating, uPVC double glazing and a single garage (B/539/-)

Leasehold Information: Lease Remaining - 976 years (as of 2026) / Service Charge - £500 per annum

Additional information

- Council Tax Band: B
- Energy Efficiency Rating: C

Viewing

Viewing strictly by appointment – details below

Disclaimer

O'Riordan Bond Estate Agents Limited has not tested apparatus, equipment, fittings or services and so cannot verify they are in working order. The buyer is advised to obtain verification from their solicitor or surveyor.

O'Riordan Bond Duston Sales
01604 589007

duston@oriordanbond.co.uk

